

Top Case Trekker Outback EVO



The Trekker Outback EVO top case is made of black painted or silver-colored aluminum and is available in two sizes (58 liters and 42 liters). The 58 liter top case can accommodate two modular or full-face helmets and the 42 liter top case can easily accommodate one helmet. The top cases are equipped with eyelets at the top and bottom corners so that bags or other items can be attached securely and conveniently. They also have a security lock and a shock and vibration-absorbing mat for the bottom of the case. A new system (Adjustable Resistance Hinging System) has been developed for the lid hinges, so that the closing speed can be adjusted at will to avoid problems when stopping on slopes.

Doesn't fit on the original BMW top case mounting. You also need the GIVI top case mounting. See our article "Top case mounting"!

Note: The top case does not fit top case mountings with a brake light kit!

Note: It is possible to retrofit up to three GIVI cases (side cases / top cases) with the same lock, so that only a single key is required to open and close the different cases. This 3-piece lock set can be ordered under item number SL103. The locks must be replaced by the customer.

Art-Nr.: OBKE58A	433,60 EUR
Top case Trekker Outback EVO 58L silver	
Art-Nr.: OBKE42B	374,40 EUR
Top case Trekker Outback EVO 42L black	
Art-Nr.: E240	69,00 EUR
Back Rest Pillion Rider for 58L topcase	
Art-Nr.: E241	64,00 EUR
Back Rest Pillion Rider for 42L topcase	
Art-Nr.: E161	17,00 EUR
Luggage net for 58L topcase	
Art-Nr.: E168	12,00 EUR

Luggage net for 42L topcase

Art-Nr.: E185

25,50 EUR

Handle for OBKE58A, OBKE58B, OBKE42A & OBKE42B

Art-Nr.: SL103

44,90 EUR

3-piece lock set (3 locks keyed alike including keys)

Additional pictures:



OBKE58A



E240



E241



E168



E161

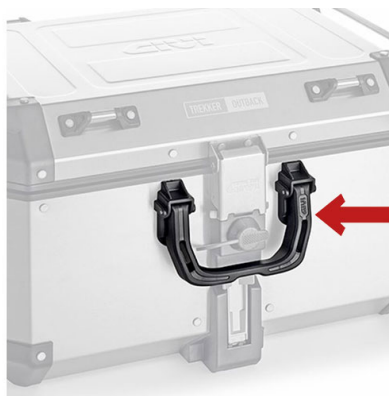

E185